

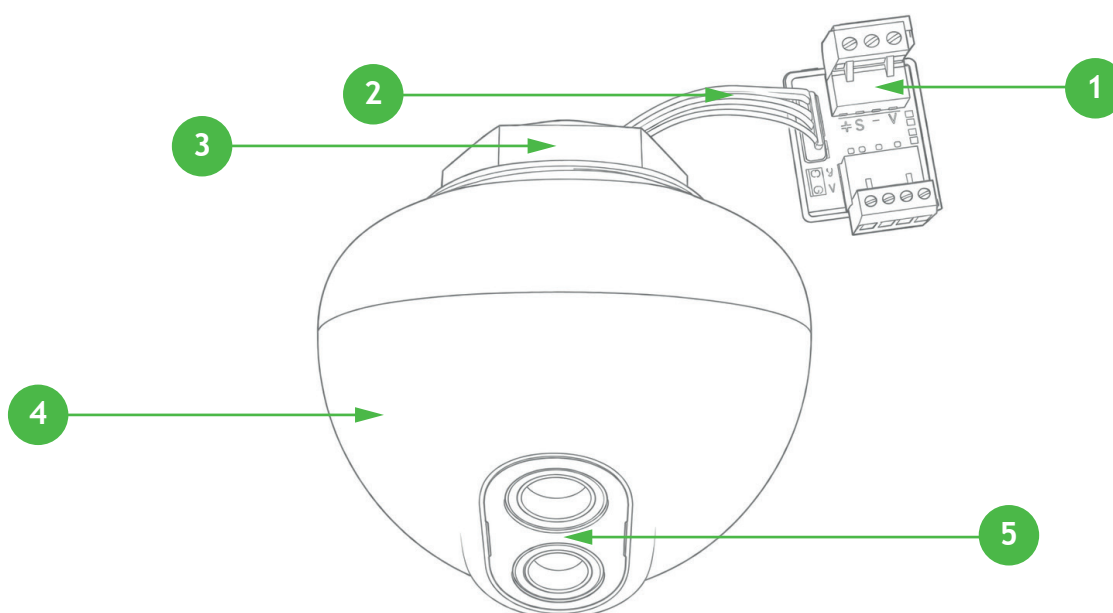

User Guide for Ultrasonic Sensor with LED indicator (All in one)

1: The appearance for Ultrasonic Sensor



No.	Component Description
1	Power communication adapter (24V, GND, B, A)
2	Connecting wire between sensor and adapter (8-core wire with sensor)
3	Sensor mounting base
4	Parking space indicator (red light for cars / green light for vacant spaces / purple for reserved parking spaces)
5	2pcs ultrasonic sensors for receiving and transmitting.

2: Installation requirements

Integrated ultrasonic parking sensor position diagram

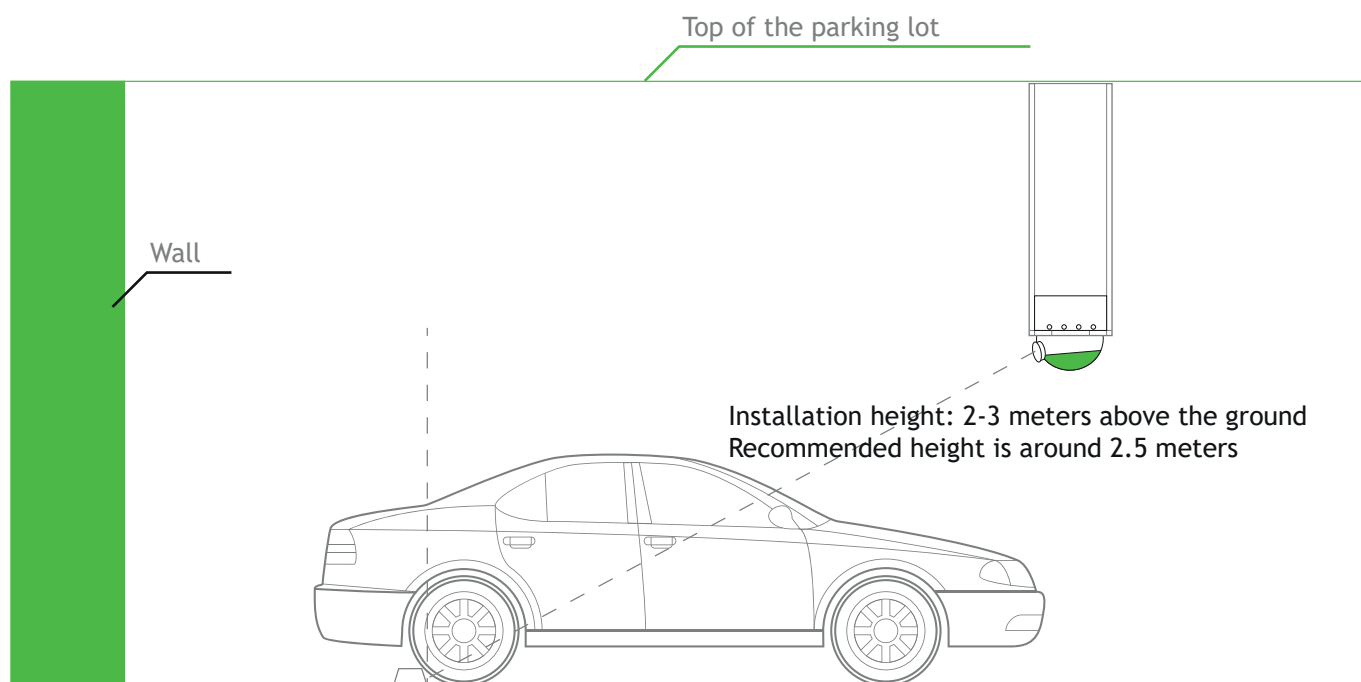

Installation distance: 3.9-4.5 meters in front of the vehicle locator, with a suggested distance of around 4.2 meters.

3: The equipment installation steps are as follows:

Step-1 Drill a hole with a diameter of $\Phi 40$ at the corresponding position on the bridge.

Step-2 Pass the detector base through the hole drilled in Step 1.

Step-3 Tighten the nut by rotating it clockwise to secure the detector to the bridge.

Step-4 Connect the extended wires to the power and communication adapter board. (Note: The ultrasonic probe of the detector should face the parking space.)

Step-5 Adjust the detector's horizontal direction and angle relative to the ground.

Step-6 Use the parking space guidance remote to set the address code and distance parameters according to the design standards in the blueprint.

4: Remote control instruction

The remote control is as follows:



The parameters that can be set on the screen are:

1. Address: Set the address code (between 1 and 30).
2. The detection distance can be set to 0-6M (integrated installation height is reduced by 20cm).
3. Equipment type, which can be set as sensor (DTT) and testing mode (TST).
4. Working mode, offline (off) or online (on). In online mode, if there is no RS485 connection within one second, the sensor will blink white. Offline mode does not blink.
5. Display type, normal mode (red and green display), VIP (red and blue display) and reservation mode (purple display)

There are 9 buttons below, and their functions are shown in the above figure. Up, down, left and right are used to select what parameters to set, and the cursor will blink at the currently set value. Add and subtract keys to change the parameter value. The read key can read the current information of the device. After setting the parameters on the screen, click the setting key to set the corresponding parameters of the equipment.

The method of application:

1. Initialization is completed in about 1 second after power-on, and the above data is displayed on the screen.
2. Press the read key to read the current device value (this step can be skipped).
3. Use the up, down, left and right keys to select the parameter to be modified, and press add and subtract to modify it to the required value.
4. After modification, press the Set key to complete the modification. If the device receives the modification information and the modification is successful, it will lash red and green respectively.